

WOODILEE  
SITE 2  
ASHTON GATE

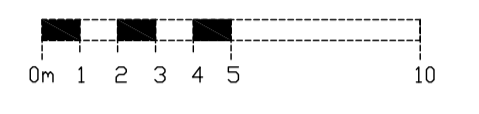

- LEGEND
- SITE BOUNDARY
  - ROADS & PARKING
  - FOOTPATHS
  - COMMON GARDEN AREA
  - GARDEN AREA ATTACHED TO ADJACENT
  - OTHER COMMON SOFT LANDSCAPING
  - FOOTPRINT OF BUILDINGS
  - BIN STORES
  - PATIO AREA

The Development registered under title DMB86439 and plots 30 to 41 within have been DPA approved by:  
*Craig McFadden - 26 March 2015*  
Craig McFadden ( DPA Officer)

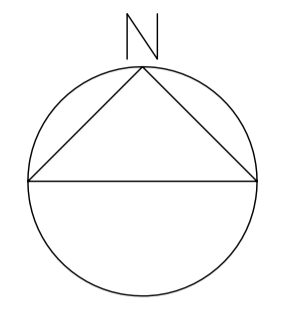

note  
do not scale  
check all dimensions on site prior to erection or fabrication and report any discrepancies to the architect immediately

rev	date	by	chkd	description
A	20.01.2012	RA		PATIO / PRIVATE SPACE ADDED AS PER LANDSCAPE ARCHITECT PROPOSAL
B	10.02.2015	RM		EASTINGS AND NORTHINGS GRID REF SHOWN
C	13.02.2015	RM		ORIGIN RESET TO OS COORDINATES

rev	date	by	chkd	description

client SANCTUARY SCOTLAND HOUSING ASSOCIATION  
project AFFORDABLE HOUSING WOODILEE, LENZIE SITE 2  
drawing SITE PLAN SITE 2 (ASHTON GATE) FOR DEEDS OF CONDITIONS

project no. 403  
drawing no. L(9)-62 revision C  
scale 1:200  
status AS BUILT  
drawn AF checked RA  
date OCT 2014

**macmon**  
chartered architects  
93 st george's road glasgow g3 6ja  
tel: 0141 332 7464 fax: 0141 333 1081  
email: info@macmon.co.uk

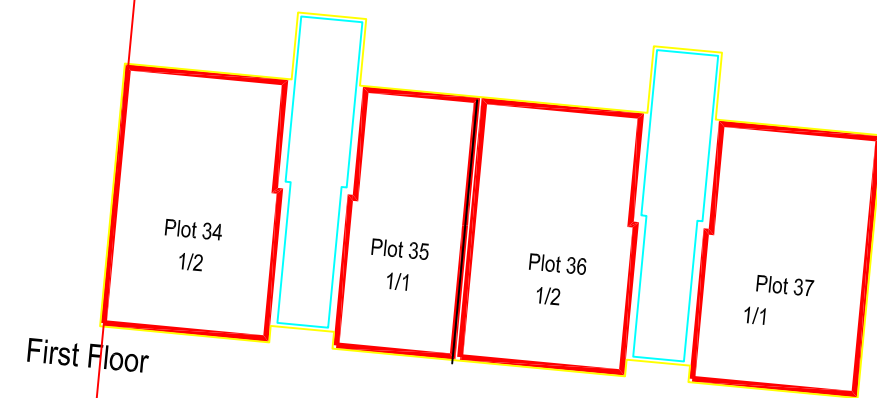
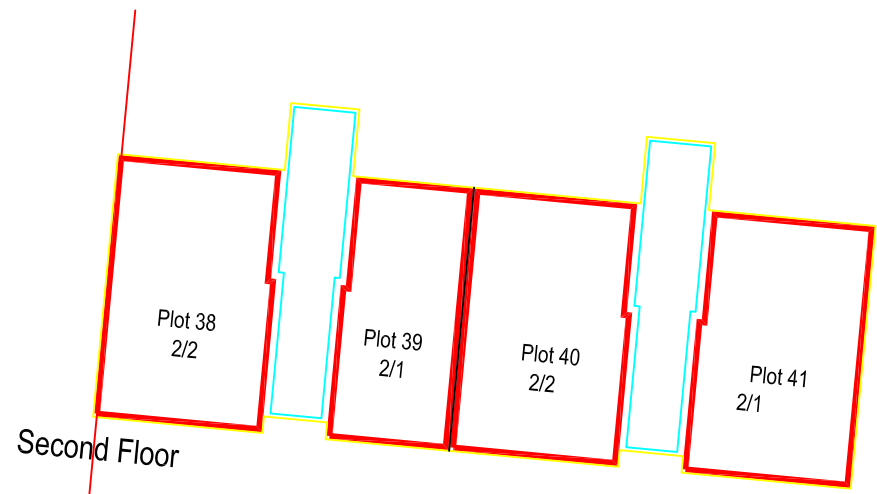

2 Ashton Gate      4 Ashton Gate

PLOT LOCATION PLANS SITE 2 WOODILEE